

7

Follow the instructions on the APP to initiate the installation sequence. When requested to unplug the power from the Hub, please disconnect AC power first, then remove AA batteries, and reinsert AA batteries before plugging AC Power back in, then tap the "OK" button

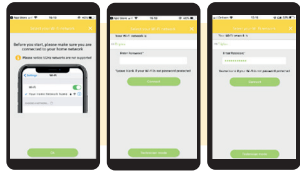

batteries back in the hub and plug in the AC power, please check to ensure that you are connected to your selected WiFi network

8

Note: If you do not see your network in "Your Wi-Fi network is:" -> verify that you are connected to the required network -> tap on the "X" -> Accept to cancel the installation -> connect your mobile phone to the required network -> and restart the installation. If the HUB can't connect to the Wi-Fi please refer to Technician Mode and follow the instructions.

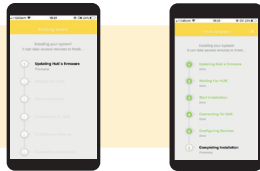

9

After the Hub connects to the Wi-Fi the installation will start automatically

10

Connect the solenoids to Irrigation controller channels

Part No.	CLM-IRAMAP-1-02, CLM-IREMEA-1-02
Product description	Irrigation Controller for 24VAC solenoid irrigation valves
Dimensions	130x26x130mm (5.11x1.02x5.11")
Weight	220gr (7.76 Oz)
Power supply	External Adaptor Input 24V AC
Operation voltage	24VAC
Operating RF	868/915 MHz
Transmission range	Open space - up to 230 m (750 ft.) Indoor environment up to 120 m (390 ft.) Avoid installing in a metal cabinet
Working Temp.	20 to +500C (-4 to +1220F)
Certifications	FCC ID: 2AFOICIC IC: 20798-CIC

Optional Technician Mode

Installation Procedure

1

Whenever the Triple+ CLM™ Hub V2.0 cannot connect to the desired Wi-Fi network, please follow the following steps: A) Make sure that the Wi-Fi that you want to work with supports 2.4GHz. B) Tap on the "Technician mode" button.

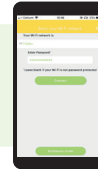

2

Follow the instructions on the APP to initiate the installation sequence. When requested to unplug the power from the Hub, please disconnect AC power first, then remove AA batteries, and reinsert AA batteries before plugging AC Power back in, then tap the "OK" button.



3

Go to the Wi-Fi network selector on your mobile phone and connect to the Triple+ Wi-Fi network the Wi-Fi name will start with "Triple+" and six characters - no password is required.



4

Return to the Triple+ App and wait for the "Successfully connected to Triple+ HUB" pop up. Tap on "Continue" and select your designated Wi-Fi network from the list. Enter password if necessary and wait for the application to give further instructions.

5

After the hub connects to the Wi-Fi the installation will start automatically

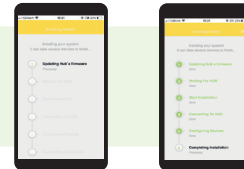

6

Locate the devices in their intended, permanent location and verify that all the devices communicate with the Triple+ CLM™ Hub V2.0 by verifying that all displaying in green. You can now secure the devices in those locations with the two-sided tape or screws.

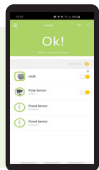

Triple+ Canada Inc.

375-700 Lawrence Ave. West Toronto, ON M6A 3B4 Canada

For more support information visit our website at:
www.tripleplus.io

IRRIGATION Smart Controller Self Installation Guide



Thank you for purchasing the Triple+ CLM™ Irrigation controller. Please follow the steps shown in this guide to properly install your new smart system.

IN THE KIT

1 X



Box Contains:
• Irrigation Controller

1 X



Box Contains:
• Power adapter
RS-24V-20VA
PRI: 230V SEC: 24V

Before you start

Search and download the Triple+ CLM APP available online or scan the QR code



Must have 2.4GHz WiFi for Irrigation Controller

Irrigation Controller wall installation



1 Using a single screw, align the Irrigation Controller to the wall.

Before you start



LED

RGB LED behavior

GREEN flashes
OK
BLUE flashes
Failure in communication with the Triple+ Cloud or with any system's device
RED flashes
battery status warning / low battery, in Hub or one of the devices.

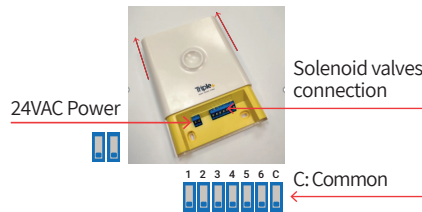

A) Connect the Irrigation Controller to a certified 24VAC Power Supply.
B) Connect the Irrigation Controller to up 6 certified 24VAC Solenoid valves (Use "C" a Common).



Triple+ CLM™ Wi-Fi Installation Instructions

1

Download the free Triple+ CLM™ APP for your smart phone from Google Play or the AppStore. The entire installation is managed via your smartphone



2

You will be registering the Triple+ CLM™ Hub V2.0 to your designated Wi-Fi network; please make sure that your mobile phone is connected to that same

Note: Our network requirements are Wi-Fi 2.4GHz only (not 5GHz).



3

Read the terms and conditions, scrolling all the way down, then tap the "I Agree button" at the bottom if you approve

4

Tap the Login button

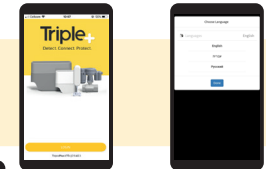

Select your language

5

Tap the Create New Account button

Fill out the required fields and tap the Accept button



Note: Ensure the complete accuracy of the email address and password requirements before accepting.

6

Tap the OK button

Tap the Add System button

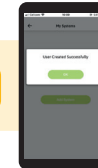

Note: If you tapped the back arrow, tap on the 3 lines on the top left corner (Main Menu) -> Settings -> Add System

7

Scan the Kit installation QR code on the OUTSIDE of the main kit box delivered

